

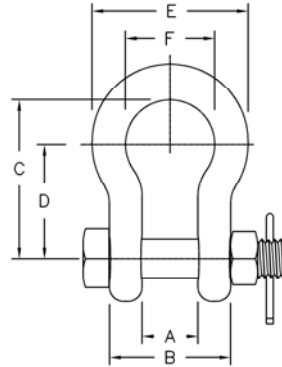

## Transmission



## Shackle /Anchor



Preformed Line Products Anchor Shackles are used to attach hardware to tower pads. All anchor shackles are manufactured to meet CSA C83 specifications for cold temperature applications and tested to 20 Jules at minus 20C.

Body: Forged Galvanized Steel

Hardware: Galvanized Steel

Cotter Pin: Stainless Steel

Catalogue Number	A Dim		B Dim		C Dim		D Dim		E Dim		F Dim		Bolt Dia	Strength		Standard Package
	In	mm	In	mm	In	mm	In	mm	IN	mm	IN	mm		LBS	KN	
AS-160C	1.1	28	2.24	57	2.91	74	2.06	52.5	3.07	78	1.69	43	3/4"	36,000	160	25
AS-222C	1.26	32	2.72	69	3.58	91	2.57	65.5	3.66	93	2	51	7/8"	50,000	222	25
AS-222C75	1.26	32	2.72	69	3.58	91	2.6	65.5	3.7	93	2	51	3/4"	50,000	222	25
AS-333C	1.38	35	2.98	75.69	5	127	3.86	98	4.04	102	2.28	57.9	1"	75,000	333	10