

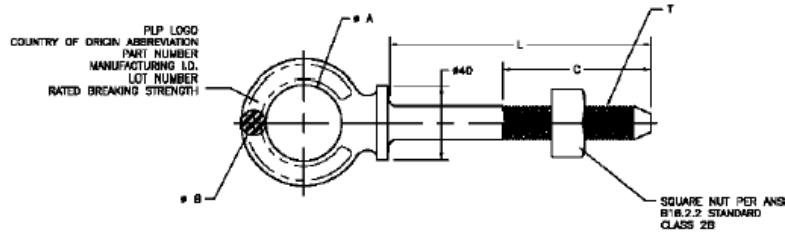

Bolt

Shoulder Eye



PLP Drop Forged Shoulder Eye Bolts are commonly used in Transmission and Distribution line work. The large shoulder eliminates the need for a washer under the eye. All Shoulder Eye Bolts are galvanized and come complete with one square or hex nut. All Bolts are tested to meet CSA C83.96 requirements for strength and energy absorption.

For hex nut add H at the end of the catalogue number

Catalogue Number	Strength	T	A	B	C	Length (in)	Standard Package
SEB58-8	14,000 LB	5/8	34 ± 1	13 ± .5	105 ± 3	200 ± 2.5 (8")	25
SEB58-10	14,000 LB	5/8	34 ± 1	13 ± .5	155 ± 3	250 ± 2.5 (10")	25
SEB58-12	14,000 LB	5/8	44 ± 1	15 ± .5	155 ± 3	300 ± 2.5 (12")	25
SEB58-14	14,000 LB	5/8	44 ± 1	15 ± .5	155 ± 3	350 ± 2.5 (14")	20
SEB58-16	14,000 LB	5/8	44 ± 1	15 ± .5	155 ± 3	400 ± 2.5 (16")	20
SEB58-18	14,000 LB	5/8	44 ± 1	15 ± .5	155 ± 3	450 ± 2.5 (18")	10
SEB34-8	28,500 LB	3/4	34 ± 1	13 ± .5	105 ± 3	200 ± 2.5 (8")	25
SEB34-10	28,500 LB	3/4	34 ± 1	13 ± .5	155 ± 3	250 ± 2.5 (10")	25
SEB34-12	28,500 LB	3/4	44 ± 1	15 ± .5	155 ± 3	300 ± 2.5 (12")	25
SEB34-14	28,500 LB	3/4	44 ± 1	15 ± .5	155 ± 3	350 ± 2.5 (14")	20
SEB34-16	28,500 LB	3/4	44 ± 1	15 ± .5	155 ± 3	400 ± 2.5 (16")	20
SEB34-18	28,500 LB	3/4	44 ± 1	15 ± .5	155 ± 3	450 ± 2.5 (18")	10
SEB34-20	28,500 LB	3/4	44 ± 1	15 ± .5	155 ± 3	500 ± 2.5 (20")	10
SEB34-22	28,500 LB	3/4	44 ± 1	15 ± .5	155 ± 3	550 ± 2.5 (22")	10